

Grand View Campus Map

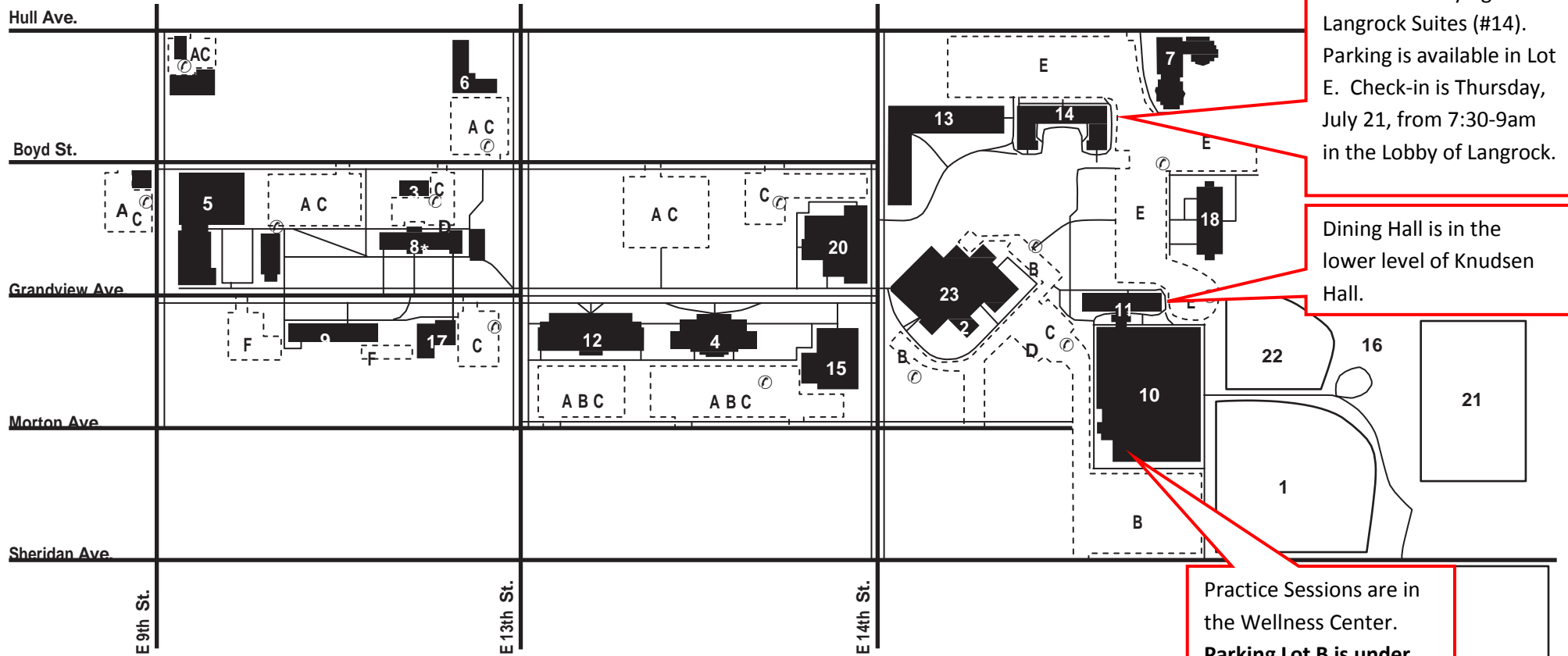

- * Admissions
- 1 Baseball Field
- 2 Bookstore
- 3 Buildings and Grounds
- 4 Cowles Communication Center
- 5 Elings Hall
- 6 Grand View Lutheran Church
- 7 Hull Apartments
- 8 Humphrey Center (Old Main)
- 9 Jensen Hall
- 10 Johnson Wellness Center**
- 11 Knudsen Hall
- 12 Krumm Business Center

- 13 L Apartments
- 14 Langrock Suites**
- 15 Library
- 16 Luhrs Athletic Complex
- 17 Luther Memorial Church
- 18 Nielsen Hall
- 19 Practice Field
- 20 Rasmussen Center for Community Advancement Professions
- 21 Soccer Field
- 22 Softball Field
- 23 Student Center

- A Commuter Student Parking (green)
- B Resident Hall Parking (yellow)
- C Faculty/Staff Parking (blue)
- D Visitor Parking
- E Reserved Resident Parking (orange)**
- F Reserved Jensen Hall Parking (gold)

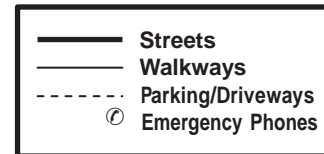

We will be staying in the Langrock Suites (#14). Parking is available in Lot E. Check-in is Thursday, July 21, from 7:30-9am in the Lobby of Langrock.

Dining Hall is in the lower level of Knudsen Hall.

Practice Sessions are in the Wellness Center. Parking Lot B is under construction and not open. Park in Lot E.